

SPARKS CROSSING

101 LOS ALTOS PARKWAY, SPARKS, NV 89436



▶ PROPERTY DETAILS

Total Square Footage: 335,981 SF

▶ PROPERTY DESCRIPTION

Sparks Crossing is a 335,981 SF shopping center in Sparks, NV (Reno MSA). Built in 2007, this well located center features a strong lineup of national tenants including Ross, Five Below, Painted Tree, Best Buy, Michaels, PetSmart, Ulta, and Dollar Tree.

The center is located at the intersection of Pyramid Way and Los Altos Parkway (55,000 VPD), the dominant retail node of northeast Reno. It's also located in close proximity to Walmart Supercenter, Costco, Home Depot, and many other national retailers.

▶ DEMOGRAPHICS

	3 Miles	5 Miles	10 Miles
Total Population	91,568	181,901	408,700
Average Household Income	\$87,951	\$80,251	\$86,655
2023 Household Estimate	32,757	67,327	159,175

▶ TENANTS



SPARKS CROSSING

101 LOS ALTOS PARKWAY, SPARKS, NV 89436

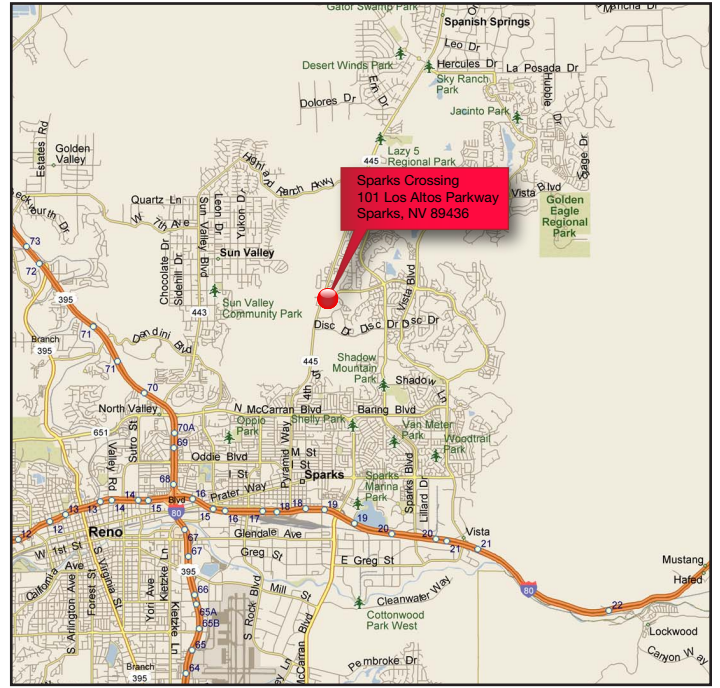
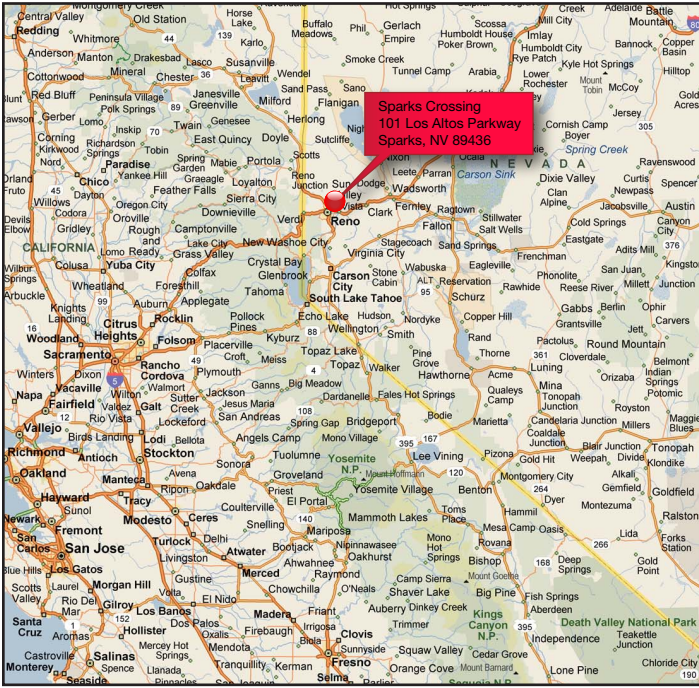

TENANT ROSTER		
SUITE	TENANT	SIZE
155	Best Buy	30,000 SF
165	Michaels	22,024 SF
171	White Daisy	2,400 SF
177	Ulta	10,020 SF
185	Coming Soon	18,300 SF
195	Painted Tree	29,982 SF
205	Five Below	10,000 SF
215	Ross Dress For Less	30,187 SF
221	Available	7,020 SF
223	Available	7,000 SF
227	Maurices	7,000 SF
235	Home Express Furniture	20,182 SF
245	Mor Furniture For Less	20,059 SF
255	PetSmart	20,087 SF
263	Dollar Tree	9,940 SF
271-115	Ace Cleaners	1,000 SF
271-113	Image Studios	7,000 SF
279-101	AT&T	3,200 SF
279-107	Pacific Sun Tan	1,600 SF
279-109	Available	1,600 SF
279-111	Mattress Land	4,200 SF
287-101	SuperCuts	1,200 SF
287-103	Twisted Sugar	1,200 SF
287-105	Havell Indian Cuisine & Bar	3,600 SF
287-111	Panda Express	2,400 SF
295-101	Jalapeno's	1,400 SF
295-103	Great Basin Federal Credit	3,500 SF
295-107	Blind Onion Pizza & Pub	4,200 SF
105-111	SMILE Shop	3,500 SF
105-107	ShearZ	1,400 SF
105-105	Available	1,400 SF
105-101	Verizon Wireless	2,800 SF
113-100	Yogurt Beach	1,500 SF
113-102	The Cake Slice	1,200 SF
113-104	Ding Tea	1,200 SF
113-106	Sew Everlasting	1,200 SF
113-108	GourMelt Grilled Cheese	1,500 SF
113-101	Nekter Juice Bar	1,500 SF
113-103	9 Rounds	1,200 SF
113-105	3D Brows Studio	1,200 SF
113-107	Beyond Nails	1,200 SF
113-109	Noodle Cafe	1,500 SF
121-105	Asian Grill & Mongolian BBQ	3,150 SF
121-103	C's Mad Batter Cakery	1,400 SF
121-101	Art in Motion	1,750 SF
129-101	Wing Stop	1,500 SF
129-113	Boot Barn	9,200 SF
129-119	C.J. Palace	3,600 SF
137	Mr. Crab	5,860 SF
OP	Available	1 Acre
TOTAL		329,061 SF

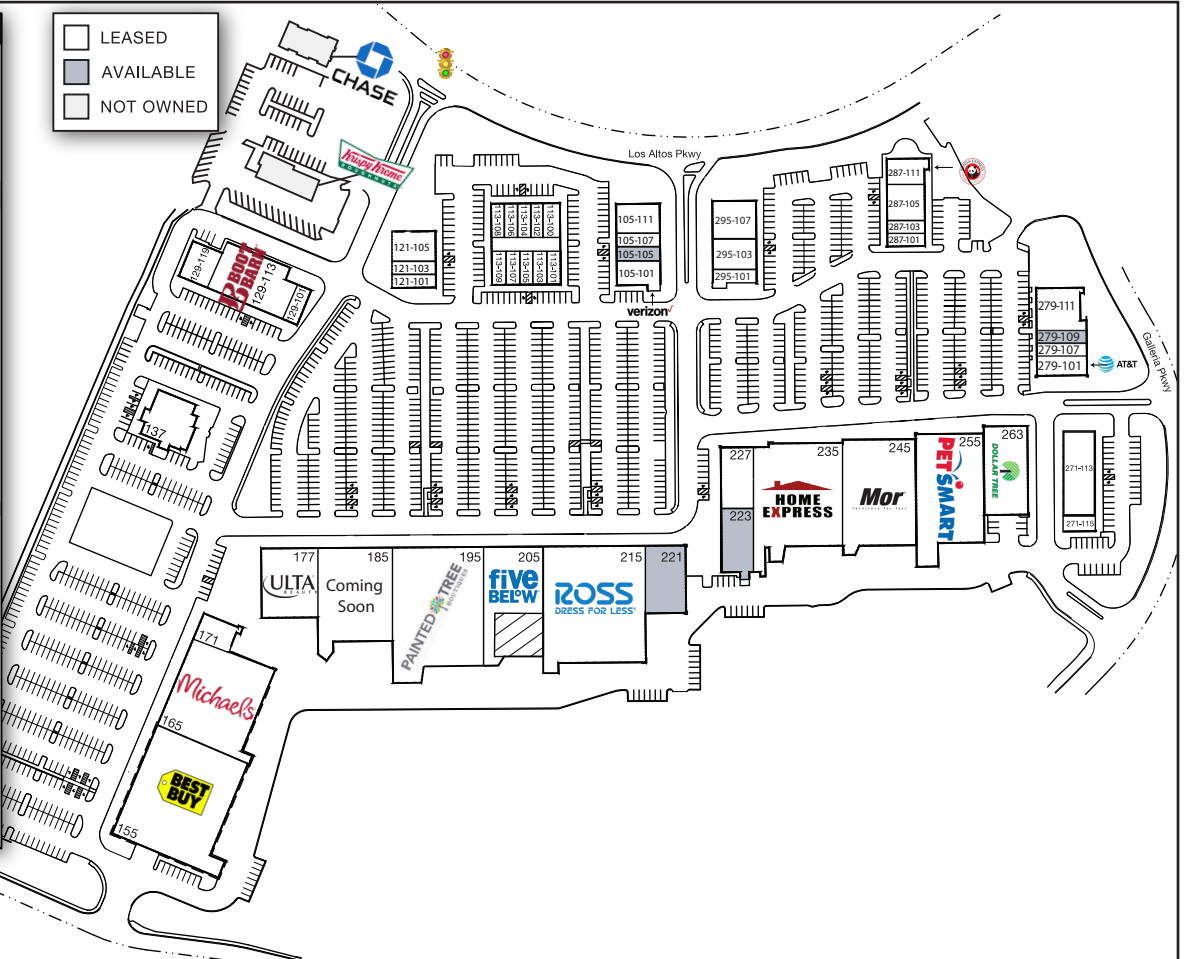

For more information contact: Kevin Donegan | kevind@rcgventures.com | 404.665.1126
www.rcgventures.com